

Spare Parts List

2 Posts Lift

Model OSA3500NH

(High Post Standard Model with Asymmetric Arms)

Production Year - April 2016~

(Without Pricing)

Contents

	(Page)
Contents	1)
1 Overall View	2) ~ 3)
2 Post, Beam & Base	4) ~ 5)
3 Cylinder	6) ~ 7)
4 Main Carriage Assy	8) ~ 9)
5 Sub Carriage Assy	10) ~ 11)
6 Hyd. Unit and Control etc.	12) ~ 15)
7 Synchronizing Chain and Piping	16) ~ 17)
8 Lift Arm R·L and Parts	18) ~ 19)
9 S. Lift Arm R·L and Parts	20) ~ 21)
10 History and Applicable Adjustable Supporter Assy (Information for Reference Only)	22) ~ 23)
11 Optional Frame Attachment (Truck Adaptor)	24) ~ 25)
12 Caution Labels	26)

Overall View

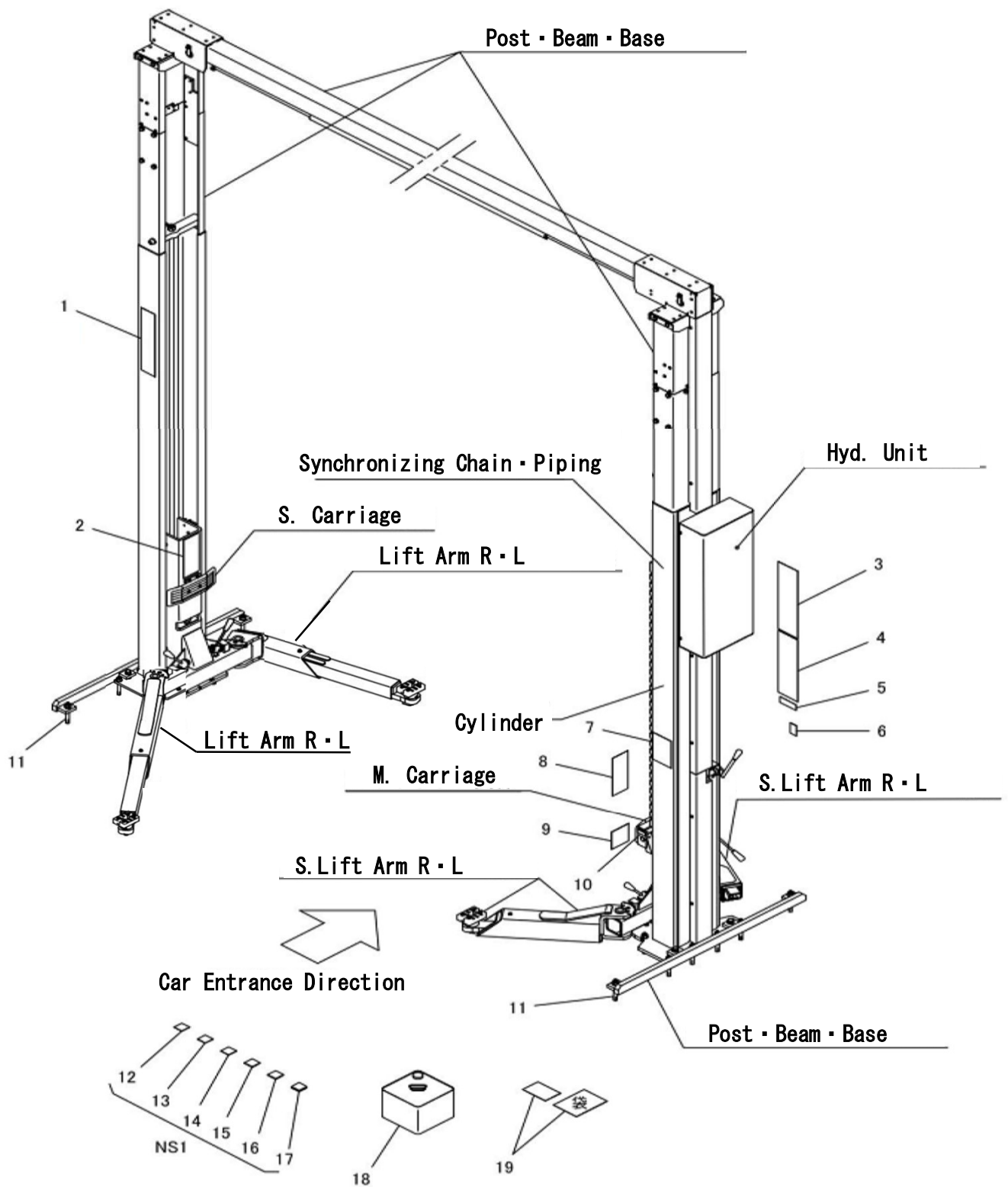

Overall View

OSA3500NH

Ill. No.	Parts No.	Parts Name	Standard	Change Date & Note	Qty /Unit	Price/ea.
NS1	10163782	Shim Set	(12~17)		1 set	
1	51311024	Bishamon Label	Refer to Page 26		1	
2	11261840	Caution Label G	Refer to Page 26		1	
3	11261900	Caution Label M	Refer to Page 26		1	
4	11261880	Caution Label I	Refer to Page 26		1	
5	Ask	Serial Plate	Ask Bishamon		1	Ask
6	51311420	Function Sticker D	Refer to Page 26		1	
7	11261860	Caution Label H	Refer to Page 26		1	
8	11261820	Caution Label F	Refer to Page 26		1	
9	11261920	Caution Label	Refer to Page 26		1	
10	51311400	Function Sticker C	Refer to Page 26		1	
11	91011612	Anchor Bolt	AAC-1612		16	
12	10163711	Shim (0.8mm)	0.8 X 50 X 50		10	
13	10163721	Shim (1.6mm)	1.6 X 50 X 50		10	
14	10163731	Shim (3.0mm)	3.0 X 50 X 50		10	
15	10163741	Shim (4.5mm)	4.5 X 50 X 50		10	
16	10163751	Shim (6.0mm)	6.0 X 50 X 50		2	
17	10163761	Shim (9.0mm)	9.0 X 50 X 50		2	
18	50564841	Bishamon Oil (8L)	Option		1	
19	38000656	Chain & Cable Replacing Schedule Label			1	

Post, Beam & Base

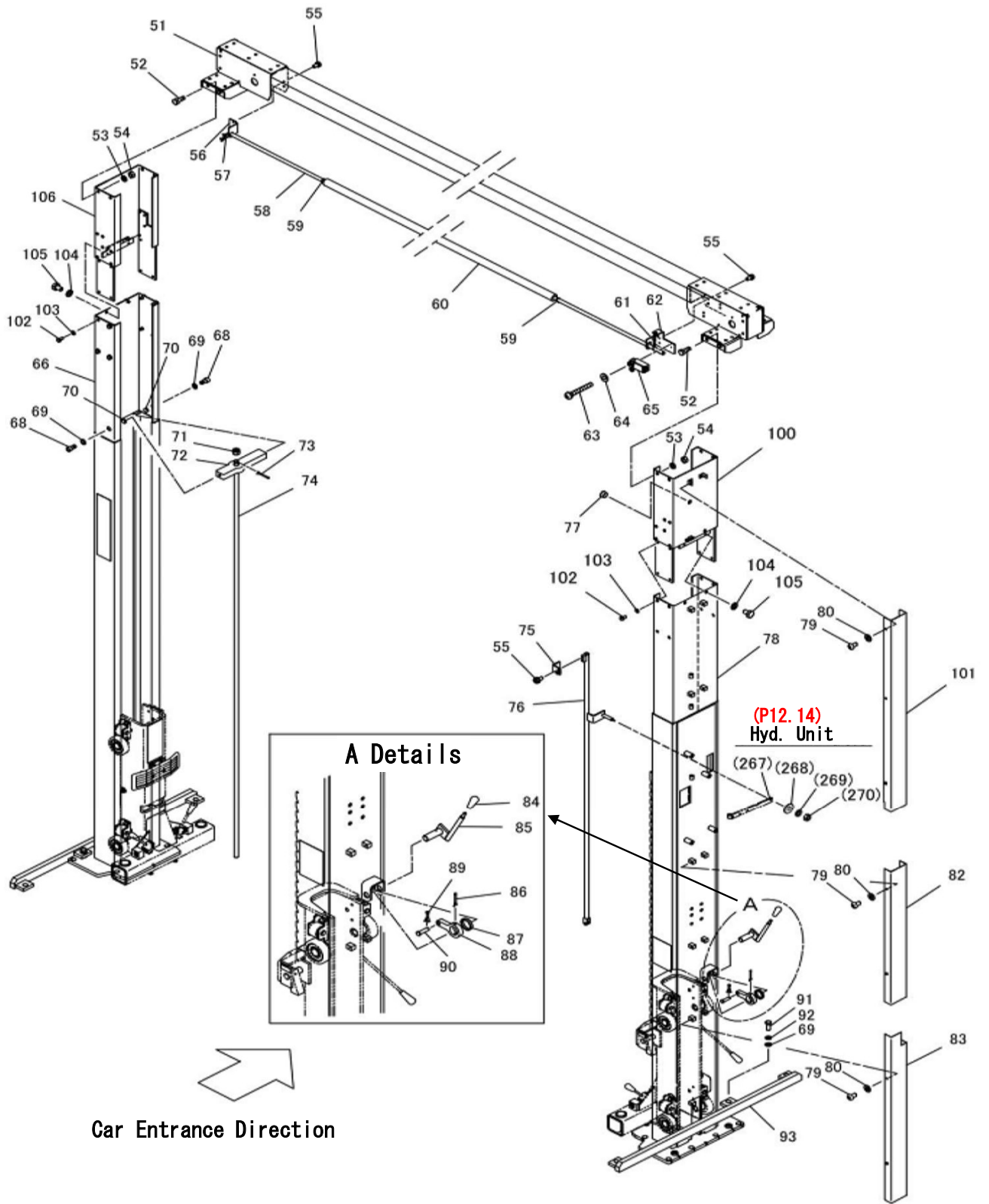

Post, Beam & Base

OSA3500NH

Ill. No.	Parts No.	Parts Name	Standard	Change Date & Note	Qty /Unit	Price/ea.
51	04543260	Post Beam			1	
52	90911230	Hex Bolt	HB1230SE		8	
53	90930512	Spring Washer	SW12SE		8	
54	90930112	Hex Nut	HN12SE		8	
55	90770815	Hex Bolt	HBS0815SE		6	
56	11250440	Sensor Stay A			1	
57	90973031	Cotter Pin	SP0330SE		2	
58	11253840	Roof Sensor Bar			1	
59	80825293	Plastic Strap	CV-200B (Black)		2	
60	11792920	Upper Limit Cushion Tube			1	
61	11793860	Sensor Spring			1	
62	11250460	Sensor Stay B			1	
63	90800430	Pan Head Screw	MSRS0430SE		2	
64	90930704	Flat Washer	PW04SE		2	
65	04552040	Upper Limit Switch Assy	D4N-2120	Omron	1	
66	N/A	S Post (Not Available because Post is structural parts)			1	N/A
67	98279126	Locking Hole Plug	O562		8	
68	90921630	Hex Socket Head Bolt	HSB1630		2	
69	90930716	Flat Washer	PW16SE		6	
70	11318820	Safety Bar Holder Collar			2	
71	90932120	Hex Nut	CN20P1.5SE		1	
72	11318800	Safety Bar Holder			1	
73	90974041	Cotter Pin	SP0440SE		1	
74	11320680	Safety Bar			1	
75	11315240	Rod Stopper			1	
76-1	04540120	Control Rod		Before 1703001	1	
76-2	04540121	Control Rod		After 1703002	1	
77	80821680	One Touch Bushing	GB-1520		1	
78	N/A	M Post (Not Available because Post is structural parts)			1	N/A
79	90940610	Pan Head Screw	MSR0610SE		12	
80	90930706	Flat Washer	PW06SE		12	
82	11249140	Chain Case 2			1	
83	11249120	Chain Case 1			1	
84	50561801	Grip M10	M10P1.25 (Black)		1	
85	04541260	Control Shaft			1	
86	90975050	Cotter Pin	SP0550SE		1	
87	10161831	Control Shaft Collar			1	
88	11330510	Hook Release Plate			1	
89	90973016	Cotter Pin	SP0315SE		1	
90	11317380	Crank Pin			1	
91	90901644	Hex Bolt	HB1640-10.9		4	
92	90930516	Spring Washer	SW16SE		4	
93	04540220	Base			2	
100	04542540	M Post Case Extention Assy			1	
101	11253040	Chain Case 4			1	
102	90911220	Hex Bolt	HB1220SE		16	
103	90930512	Spring Washer	SW12SE		16	
104	90930510	Spring Washer	SW10SE		4	
105	90911015	Hex Bolt	HB1015SE		4	
106	04542580	S Post Case Extention Assy			1	

Cylinder

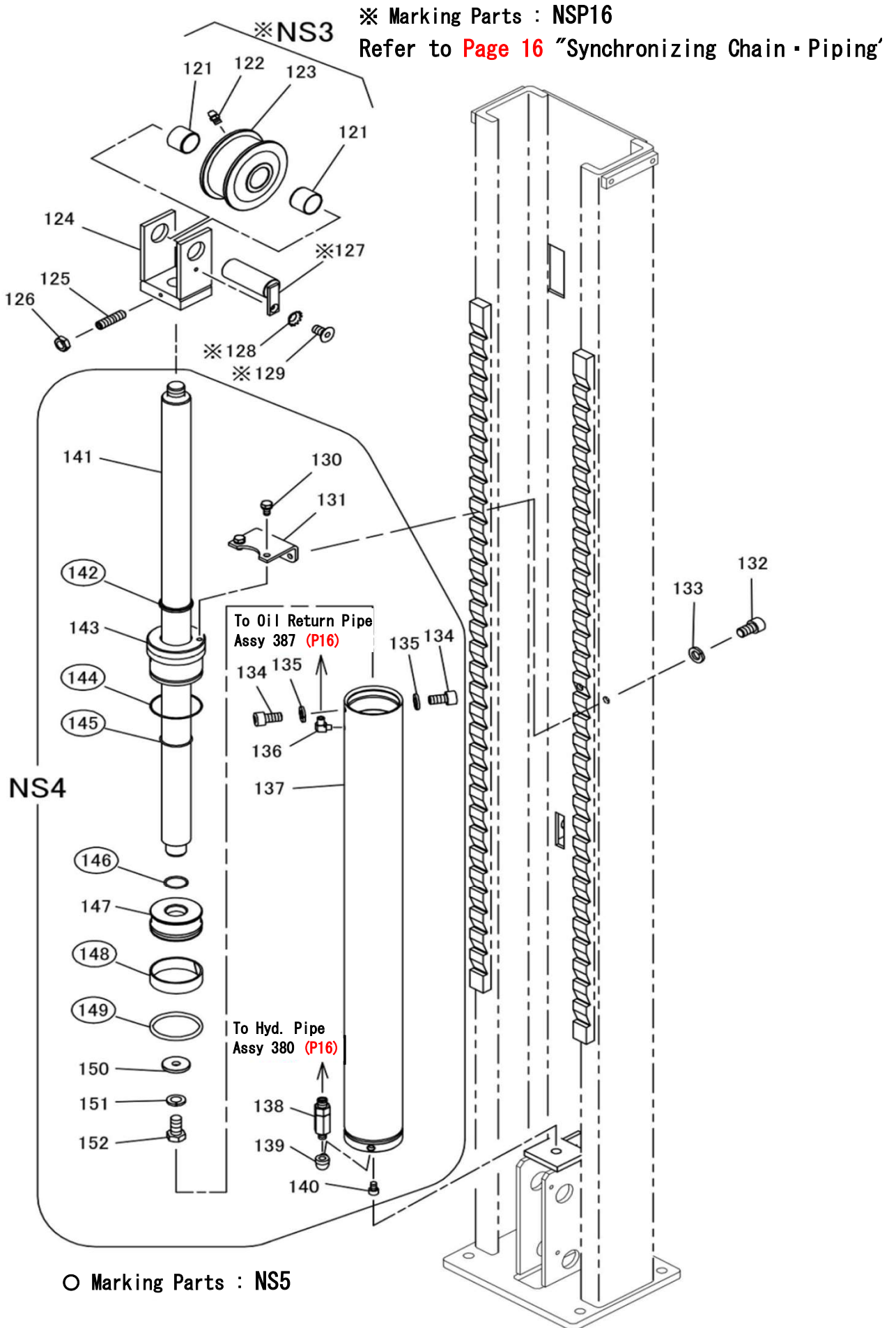

Cylinder

OSA3500NH

Ill. No.	Parts No.	Parts Name	Standard	Change Date & Note	Qty /Unit	Price/ea.
NS3	00098410	Chain Wheel A Assy	(121~123)		1	
NS4	75103200	Cylinder Assy	(130·131·134~152)		1	
NS5	00043342	Seal Kit	(138·140·141·142·144·145)		1	
121	81640443	#80 Bushing			2	
122	80827006	Grease Fitting	GNAM6X0. 75		1	
123	N/A	Chain Wheel A	Replace by NS3		1	N/A
124	00099540	Chain Bracket			1	
125	90960830	Hex Socket Head Screw	HSS0830		1	
126	90930308	Hex Nut	HN08 (3) SE		1	
127	04540920	Chain Wheel Shaft			1	
128	90930958	Serrated Washer	TLWF08SE		1	
129	91000815	Hex Socket Head Bolt	HSF0815		1	
130	90891020	Hex Bolt	HBS1020SE		2	
131	11250480	Cylinder Clamper			1	
132	90921220	Hex Socket Head Bolt	HSB1220		2	
133	90930512	Spring Washer	SW12SE		2	
134	90920815	Hex Socket Head Bolt	HSB0815		2	
135	90930508	Spring Washer	SW08SE		2	
136	80813906	90° Elbow	HS-E1-6X1/8		1	
137	N/A	Cylinder	Replace by NS4		1	N/A
138	80818559	Fuse Valve	FS1-02-M-30-0	(Shut Off Valve)	1	
139	80813102	Male & Female Elbow	HS-BC-1/4		1	
140	90921015	Hex Socket Head Bolt	HSB1015		1	
141	N/A	Piston Rod	Replace by NS4		1	N/A
142	80803050	Dust Seal	DH-50		1	
143	11320760	Cylinder Cover			1	
144	80800133	O Ring	G85		1	
145	80800046	O Ring	P50		1	
146	80800034	O Ring	P35		1	
147	11320780	Piston			1	
148	80804090	Wearing	84X90X25 Oiles #80		1	
149	80801080	U Packing	SKY-80 (Sakagami)		1	
150	10161161	Piston Washer			1	
151	90930412	Spring Washer	SW12		1	
152	90901225	Hex Bolt	HB1225		1	

M. Carriage Assy

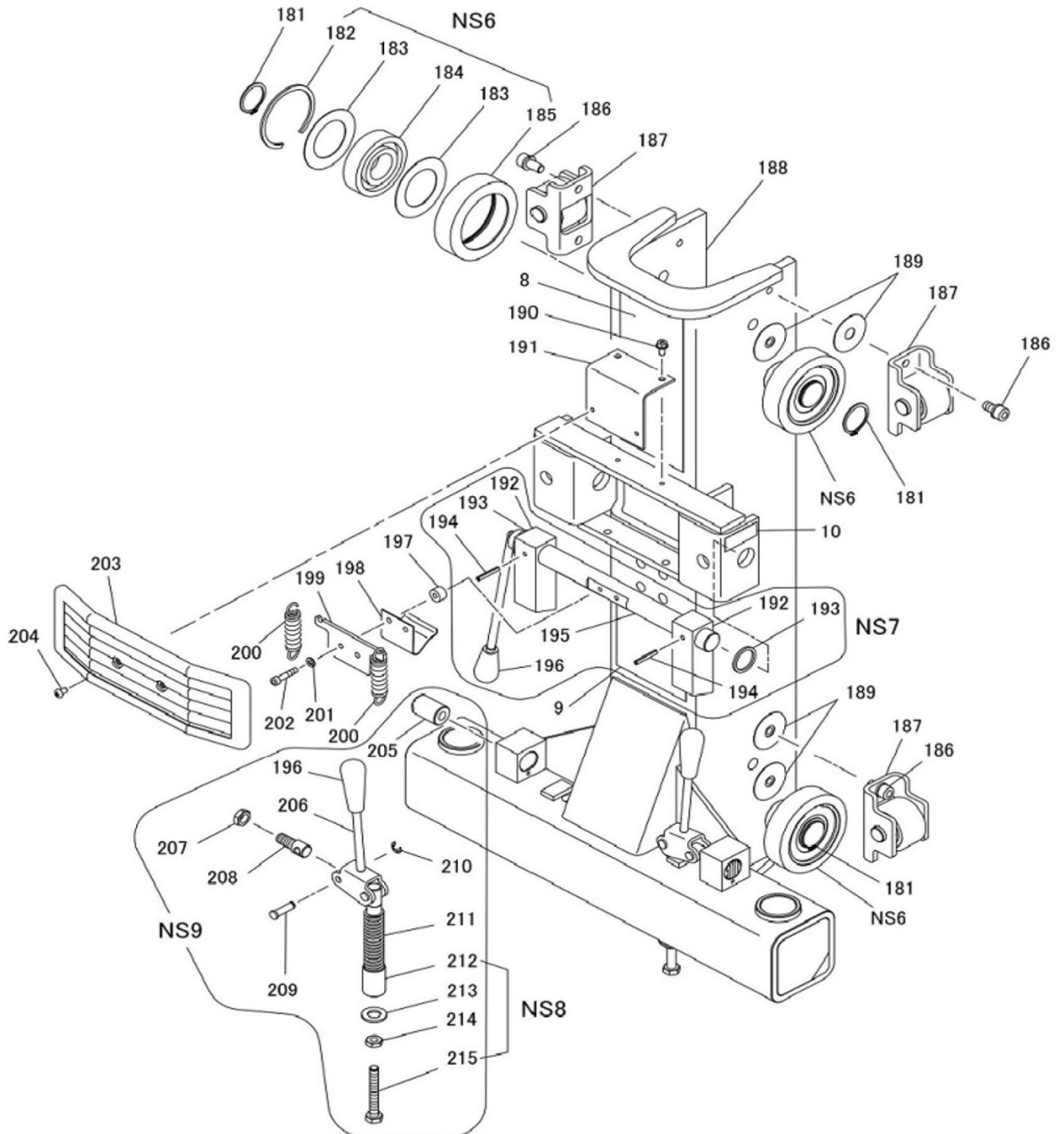

M. Carriage Assy

OSA3500NH

Ill. No.	Parts No.	Parts Name	Standard	Change Date & Note	Qty /Unit	Price/ea.
NS6	75019640	Guide Roller Assy	(182~185)		4	
NS7	00098272	M. Hook Shaft Assy	(192×2·193×2·194×2·195·196)		1	
NS8	75103240	Lock Rod Assy	(212~215)		2	
NS9	75103260	Lock Link Assy	(196·205~215)		2	
8	11261820	Caution Label F	Refer to Page 26		1	
9	11261920	Caution Label	Refer to Page 26		1	
10	51311400	Function Sticker C	Refer to Page 26		1	
181	80845022	Snap Ring	RR035		4	
182	80848580	Snap Ring	BR·AR-80		4	
183	50560611	Bearing Seal			8	
184	81026307	Bearing	6307		4	
185	N/A	Guide Roller		Replace by NS6	4	N/A
186	90761020	Hex Socket Head Bolt	HSBS1020		8	
187	00099260	Side Roller			4	
188	N/A	M. Carriage (Not Available because Carriage is structural parts)			1	N/A
189	10161760	Carriage Spacer			4	
190	90790614	Hex Bolt	HBPS0614SE		2	
191	11249400	Bumper Fixing Stay			1	
192	N/A	Lowering Stop Hook		Replace by NS7	2	N/A
193	N/A	Hook Shaft Collar		Replace by NS7	2	N/A
194	90980532	Roll Pin	SRP0532		2	
195	N/A	Hook Shaft		Replace by NS7	1	N/A
196	50561801	Grip M10	M10P1. 25 (Black)		3	
197	11315710	Safety Spacer			2	
198	51311009	Safety Spring			1	
199	11315690	Safety Spring Support			1	
200	51311001	Main Safety Spring			2	
201	90930506	Spring Washer	SW06SE		2	
202	90920630	Hex Socket Head Bolt	HSB0630		2	
203	51311095	S. Door Bumper	Black		1	
204	90940610	Pan Head Screw	MSR0610SE		2	
205	11315701	Lock Piece			2	
206	04540300	Lock Link			2	
207	90930313	Hex Nut	HN12 (3) P1. 25SE		2	
208	11482400	Lock Bar			2	
209	11315621	Lock Link Pin S			4	
210	80847510	E Shape Snap Ring	E7SE		4	
211	51311040	Lock Spring			2	
212	N/A	Lock Rod		Replace by NS8	2	N/A
213	90930714	Flat Washer	PW14SE		2	
214	90930310	Hex Nut	HN10 (3) SE		2	
215	90911070	Hex Bolt	HB1070SE		2	

S. Carriage Assy

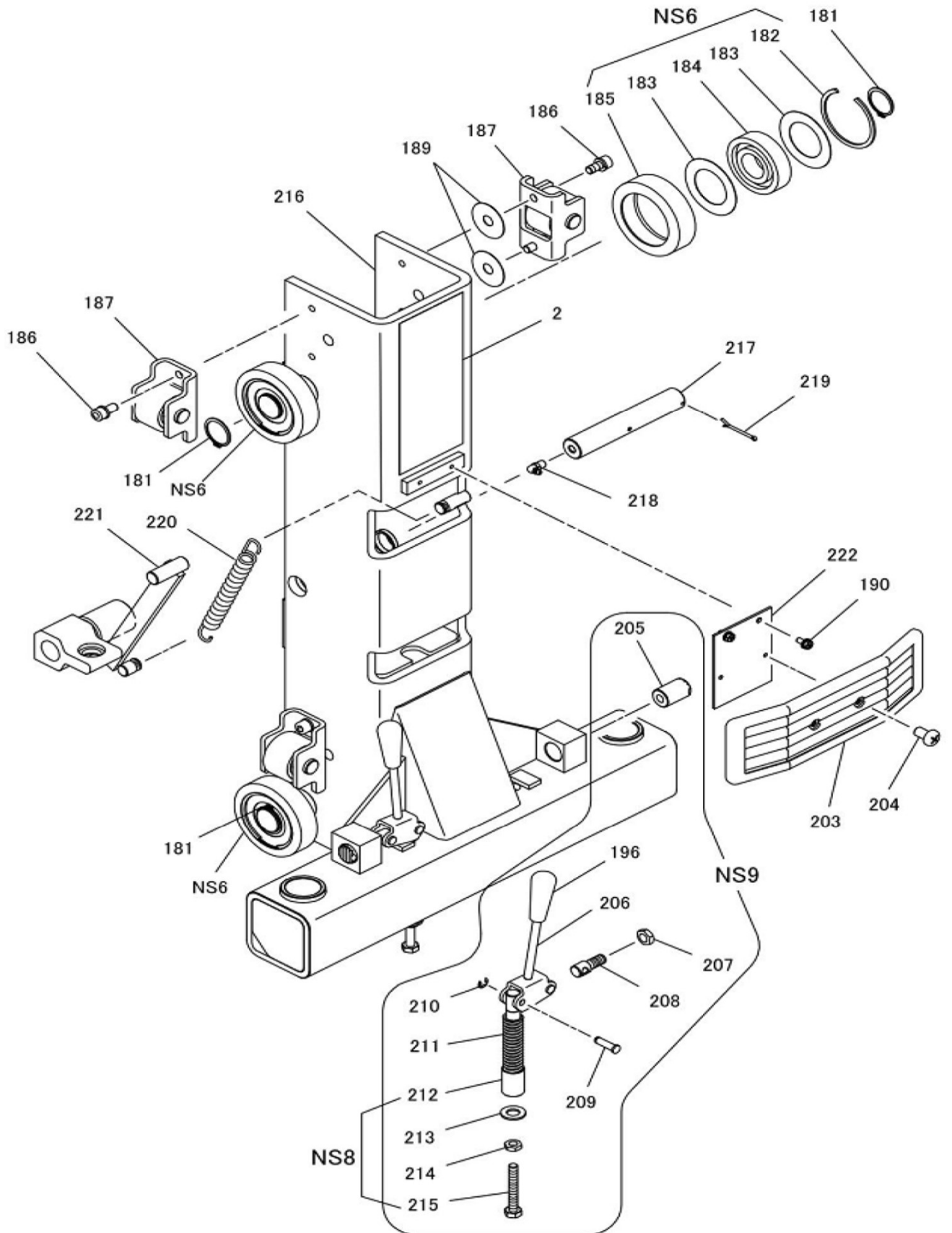

S. Carriage Assy

OSA3500NH

Ill. No.	Parts No.	Parts Name	Standard	Change Date & Note	Qty /Unit	Price/ea.
NS6	75019640	Guide Roller Assy	(182~185)		4	
NS8	75103240	Lock Rod Assy	(212~215)		2	
NS9	75103260	Lock Link Assy	(196·205~215)		2	
2	11261840	Caution Label G			1	
181	80845022	Snap Ring	RR035		4	
182	80848580	Snap Ring	BR·AR-80		4	
183	50560611	Bearing Seal			8	
184	81026307	Bearing	6307		4	
185	N/A	Guide Roller		Replace by NS6	4	N/A
186	90761020	Hex Socket Head Bolt	HSBS1020		8	
187	00099260	Side Roller			4	
189	10161760	Carriage Spacer			4	
190	90790614	Hex Bolt	HBPS0614SE		2	
196	50561801	Grip M10	M10P1.25 (Black)		2	
203	51311095	S. Door Bumper	Black		1	
204	90940610	Pan Head Screw	MSR0610SE		2	
205	11315701	Lock Piece			2	
206	04540300	Lock Link			2	
207	90930313	Hex Nut	HN12(3)P1.25SE		2	
208	11482400	Lock Bar			2	
209	11315621	Lock Link Pin S			4	
210	80847510	E Shape Snap Ring	E7SE		4	
211	51311040	Lock Spring			2	
212	N/A	Lock Rod		Replace by NS8	2	N/A
213	90930714	Flat Washer	PW14SE		2	
214	90930310	Hex Nut	HN10(3)SE		2	
215	90911070	Hex Bolt	HB1070SE		2	
216	N/A	S. Carriage (Not Available because Carriage is structural parts)			1	N/A
217	11316160	Catch Gear Shaft			1	
218	80827041	Grease Fitting	GNC1/8		1	
219	90973046	Cotter Pin	SPO345SE		1	
220	51311060	Catch Gear Spring			1	
221	00099420	Catch Gear			1	
222	11249660	Bumper Fixing Base Plate			1	

Hyd. Unit and Control etc.

(After April 2016)

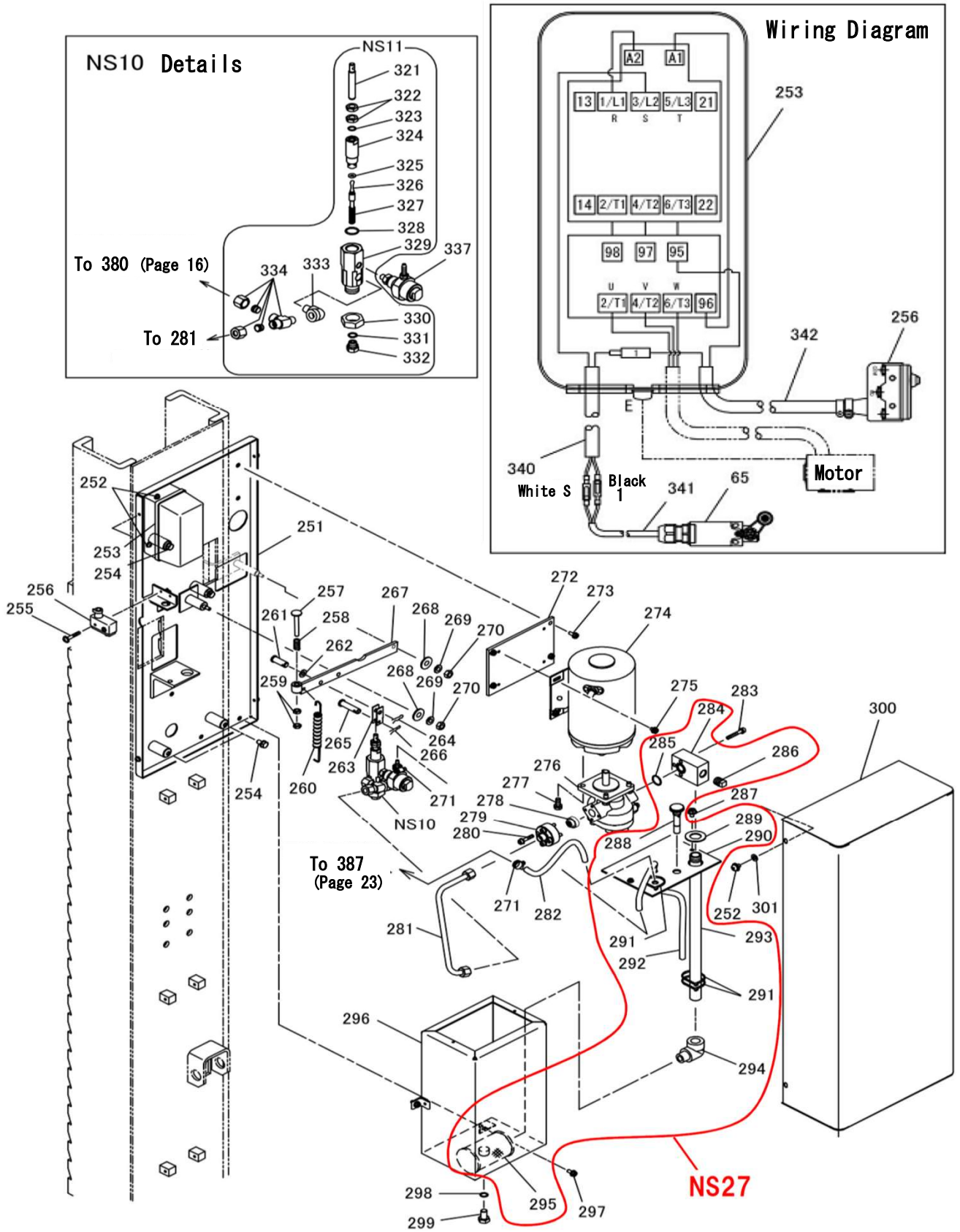

Hyd. Unit and Control etc. (After April 2016)

OSA3500NH

Ill. No.	Parts No.	Parts Name	Standard	Change Date & Note	Qty /Unit	Price/ea.
NS10	04540520	Valve Complete Assy	(NS11-337)		1	
NS11	04540540	Valve Assy	(321~334)		1	
NS27	71250000	Suction Pipe Assy	(284~286-288~295)		1	
65	04552040	Upper Limit Switch Assy	D4N-2120	Omron	1	
251	04540580	Control Panel			1	
252	90780508	Pan Head Screw	MSRPS0508SE		6	
253	30820700	Magnet Contactor (MS-N11-S5)	50HZ/200V, 60HZ/200・220V		1	
	30820720	Magnet Contactor (MS-N11-S6)	50HZ/380・400・415V, 60HZ/400・440V		1	
254	90890815	Hex Bolt	HBS0815SE		4	
255	90750425	Pan Head Screw	MSRP0425SE		2	
256	80820722	Limit Switch (Z-15GD-B+0M2)	50HZ/200V, 60HZ/200・220V - No Cable		1	
	80820756	Limit Switch (Z-15GD-B)	50HZ/380・400・415V, 60HZ/400・440V - No Cable		1	
257	10162722	Switch Pin			1	
258	50562721	Switch Plunger Spring			1	
259	90930308	Hex Nut	HN08 (3) SE		2	
260	50562582	Neutrizer Spring			1	
261	10161861	Conrod Fixing Pin			1	
262	90930708	Flat Washer	PW08SE		1	
263	10281761	Valve Adjuster Joint			1	
264	90654168	Snap Pin	Nominal Size 8mm		1	
265	50501681	Forked Pin			1	
266	80654165	Snap Pin	Nominal Size 5mm		1	
267-1	04540600	Switch Lever		Before 1703001	1	
267-2	04540601	Switch Lever		After 1703002	1	
268	90930793	Flat Washer	PW6. 5X19X1. 6SE		2	
269	90930506	Spring Washer	SW06SE		2	
270	90930106	Hex Nut	HN06SE		2	
271	80825054	Hose Band	SX-W1		2	
272	11258540	Motor Fixing Plate			1	
273	90770615	Hex Bolt	HBS0615SE		4	
274	80820013	Motor (TWC4712AG) 3PH 1.5KW	50HZ/200V, 60HZ/200・220V		1	
	80820014	Motor (TWC4712BG) 3PH 1.5KW	50HZ/380・400・415V, 60HZ/380・400・440V		1	
275	90790610	Hex Bolt	HBPS0610SE		4	
276	80818023	Gear Pump (GPEOA1-AA60L155)	50HZ/200V, 60HZ/200・220V		1	
	80818000	Gear Pump (GPEOA1-AA40L155)	50HZ/380・400・415V, 60HZ/380・400・440V		1	
277	90890820	Hex Bolt	HBS0820SE		4	
278	80818531	Check Valve	V1095-001		1	
279	11317580	Pump Joint			1	
280	90760630	Hex Socket Head Bolt	HSBS0630		4	
281	75103280	Unit Hyd. Pipe Assy	With Nut and Sleeve		1	
282	11317510	Overflow Tube	Spring Hose	11X6-350	1	
283	90760640	Hex Socket Head Bolt	HSBS0640		3	
284	11317500	Suction Joint			1	
285	80800018	O Ring	P20		1	
286	80810003	Plug	P3/8		1	
287	90740508	Hex Bolt	HBPO508SE		2	
288	00043644	Level Bar Assy			1	
289	11317490	Suction Pipe Cover			1	
290	11317470	Tank Cover			1	
291	80825291	Plastic Strap	CV-150		4	
292	11317520	Oil Returning Tube	Spring Hose	11X6-560	1	
293	11250000	Suction Pipe			1	
294	80810704	Male & Female Elbow	STE1/2SE		1	
295	80818951	Strainer	SS-40610-10		1	
296	00099481	Oil Tank			1	
297	90790615	Hex Bolt	HBPS0615SE		2	
298	80800250	O Ring	P12		1	
299	90911220	Hex Bolt	HB1220SE		1	
300	00043662	Control Panel Cover			1	
301	90930705	Flat Washer	PW05SE		4	
321	10162532	Valve Rod			1	
322	90930310	Hex Nut	HN10 (3) SE		2	
323	80800008	O Ring	P10		1	
324	10162521	Valve Housing			1	
325	80800220	O Ring	AN6227-1		1	

Hyd. Unit and Control etc.

(After April 2016)

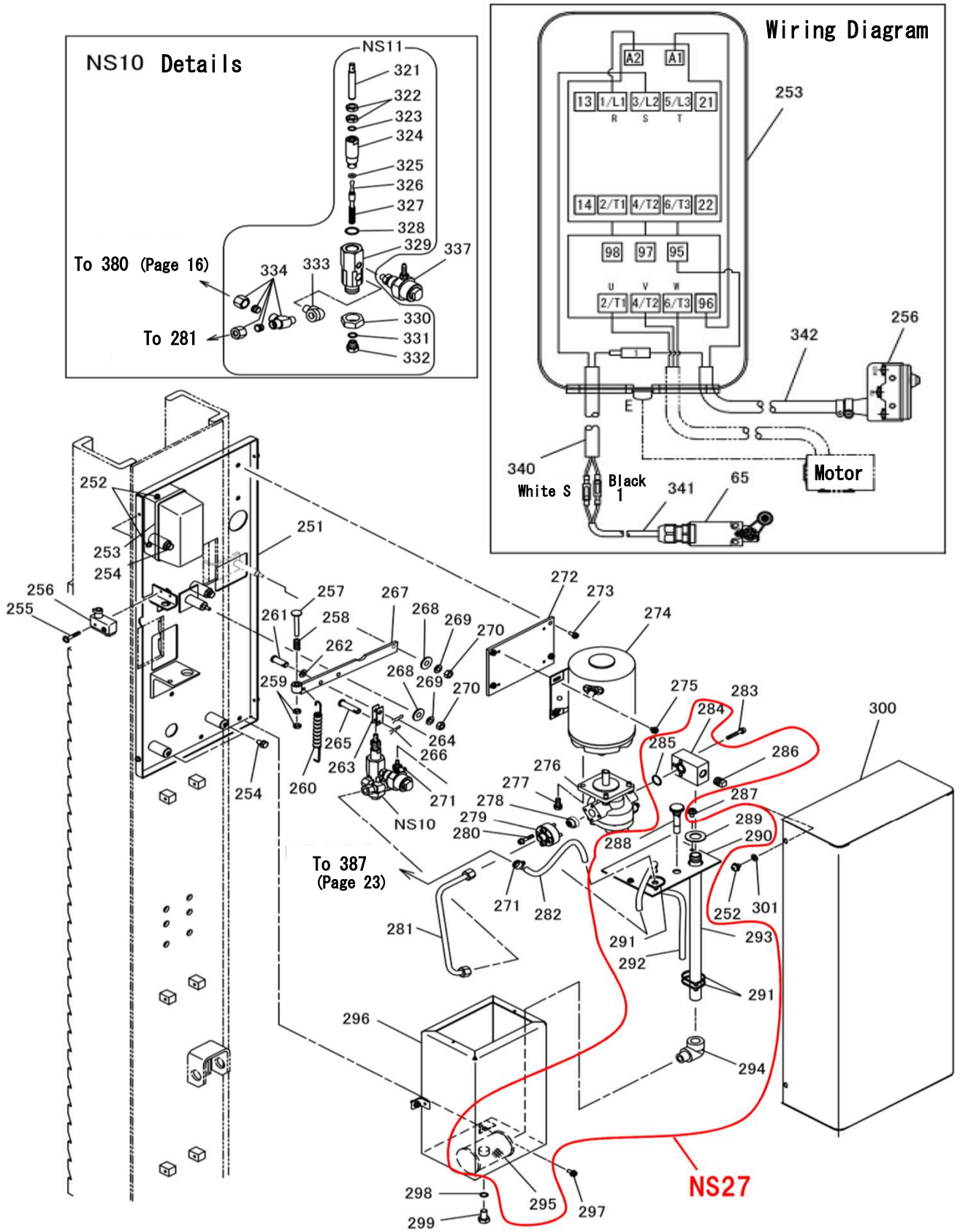

Hyd. Unit and Control etc.

OSA3500NH

Ill. No.	Parts No.	Parts Name	Standard	Change Date & Note	Qty /Unit	Price/ea.
326	11250041	Valve Plunger			1	
327	50581761	Valve Spring			1	
328	80800017	O Ring	P18		1	
329	11250020	Valve Body			1	
330	90930322	Hex Nut	HN22 (3) SE		1	
331	80800411	O Ring	JASO-1011		1	
332	11250061	Back Valve Screw			1	
333	80813102	Male and Female Elbow	HS-BC-1/4		1	
334	80817520	T Nipple	KTK10-020N	(With Nut & Sleeve)	1	
	N/A	Sleeve	HS-P2-10	Replace by 334	2	N/A
	N/A	Nut	HS-C-10	Replace by 334	2	N/A
337	04540560	Flow Control Assy			1	
340	Ask	Upper Limit Switch Cable Set S	SVCT 0.75SQX2C-250	Ask Bishamon	1	Ask
341	Ask	Upper Limit Switch Cable Set L	SVCT 0.75SQX2C-1700	Ask Bishamon	1	Ask
342	11314890	Lifting Switch Cable Set (VCTF 1.25SQX2C-300)	50HZ/200V, 60HZ/200 · 220V		1	
	11328440	Lifting Switch Cable Set (VCTF 0.75SQX2C-300)	50HZ/380 · 400 · 415V, 60HZ/400 · 440V		1	

Synchronizing Chain and Piping

★ 377-39835400 Joint Link Set

Leaf Plate(5ea.), Outer Plate, Cotter

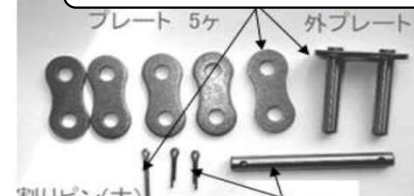

Joint link set includes Joint Pin (51311100) and 90972010 Cotter Pin (Small-2ea.).

NS16 : ※ Marking Parts

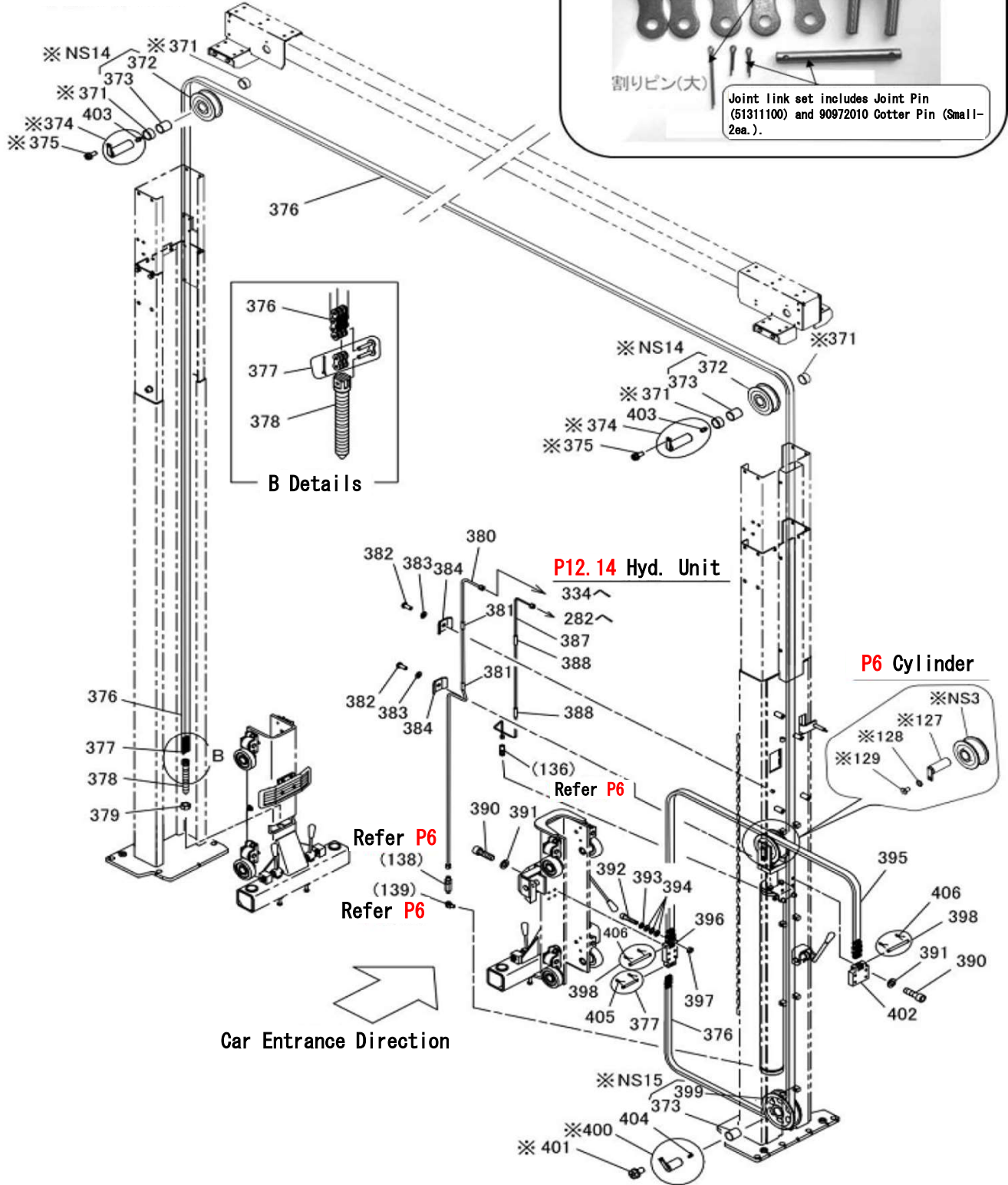

Synchronizing Chain and Piping

OSA3500NH

Ill. No.	Parts No.	Parts Name	Standard	Change Date & Note	Qty /Unit	Price/ea.
NS14	00098630	Chain Wheel B Assy	(372-373)		2	
NS15	00101650	Chain Wheel C Assy	(373-399)		1	
NS16	75103340	Chain Wheel + Shaft Set	(NS3-NS14-NS15-127~129-371-374-375-400-401)		1	
138	80818559	Fuse Valve	FS1-02-M-30-0	(Shut Off Valve)	1	
139	80813102	Male & Female Elbow	HS-BC-1/4		1	
371	11250160	Chain Wheel Collar			4	
372	N/A	Chain Wheel B		Replace by NS14	3	N/A
373	81640445	#80 Bushing	80B-4050	Oiles	4	
374	04540680	Chain Wheel Shaft B Assy	With 403 (OD Φ 40, L-119)		2	
375	90770820	Hex Bolt	HBS0820SE		2	
376	80835571	Leaf Chain Set	AL666-571L (With 377)		1	
377	39835400	Joint Link Set	For AL666	(With 405)	1	
378	11317180	Chain Adjust Screw			1	
379	90930124	Hex Nut	HN24SE		1	
380	75103300	Hyd. Pipe Assy	With Nut, Sleeve and 381		1	
381	50627500	Fixing Pipe of Hyd. Pipe			2	
382	90940615	Pan Head Screw	MSR0615SE		2	
383	90930506	Spring Washer	SW06SE		2	
384	10161371	Fixing Pipe of Hyd. Pipe			2	
387	75103320	Oil Return Pipe Assy	With Nut, Sleeve and 388		1	
388	51311120	Fixing Pipe of R6 Hyd. Pipe	Φ 7X Φ 13X50		2	
390	90921240	Hex Socket Head Bolt	HSB1240		8	
391	90930512	Spring Washer	SW12SE		8	
392	90920525	Hex Socket Head Bolt	HSB0525		2	
393	90930505	Spring Washer	SW05SE		2	
394	90930705	Flat Washer	PW05SE		6	
395	80837955	Leaf Chain (With 398)	AL866-55L		1	
396	11316500	Carriage Chain Fixing Plate			1	
397	90930105	Hex Nut	HN05SE		2	
398	51311090	Chain Fitting Pin	For AL866	With 406	2	
399	N/A	Chain Wheel C		Replace by NS15	1	N/A
400	04540720	Chain Wheel Shaft C Assy	OD- Φ 40, L-72	With 404	4	
401	90770815	Hex Bolt	HBS0815SE		4	
402	11316480	Post Chain Fixing Plate			1	
403	80827021	Grease Fitting	GNA1/8		2	
404	80827041	Grease Fitting	GNC1/8		1	
405	90972010	Cotter Pin	SP0210	Included in 377	2	
406	90972516	Cotter Pin	SP02.515SE	Included in 398	4	
19	38000656	Chain & Cable Replacing Schedule Label			1	

Lift Arm R·L and Parts

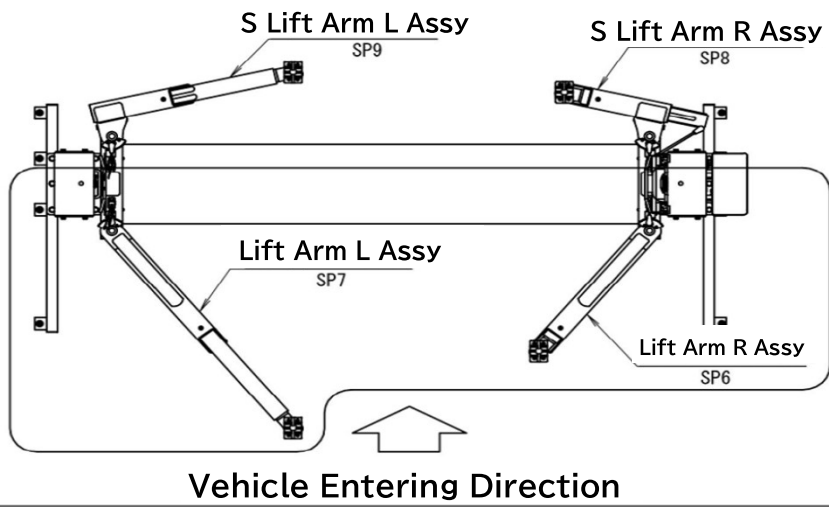

NS19 - Adjustable Supporter Assy

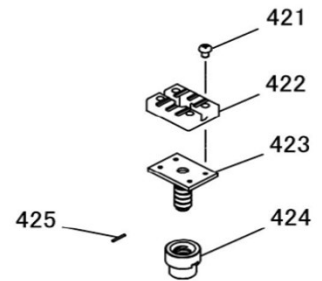

SP6 Lift Arm R Assy

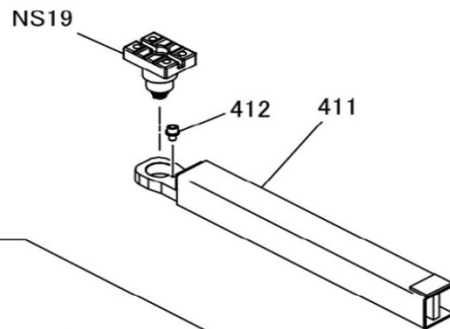

SP7 Lift Arm L Assy

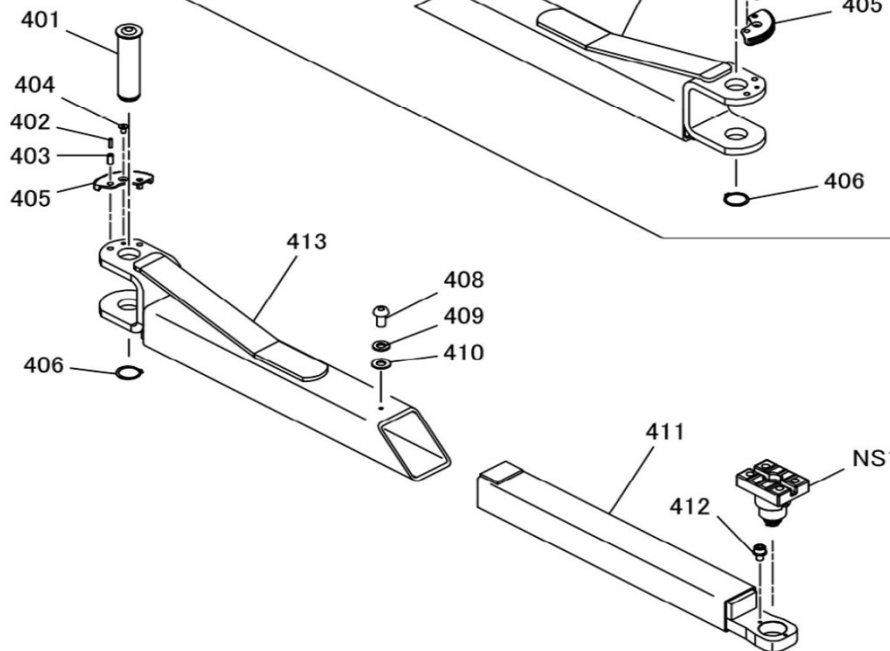

Lift Arm R·L and Parts

OSA3500NH

Ill. No.	Parts No.	Parts Name	Standard	Change Date & Note	Qty /Unit	Price/ea.
SP6	30318620	Lift Arm R Assy	(401~412・NS19)		1	
	04548340	Lift Arm R Assy	(401~412)	NS19 Not Included	1	Ask
SP7	30318660	Lift Arm L Assy	(401~406・408~413・NS19)		1	
	04548400	Lift Arm L Assy	(401~406・408~413)	NS19 Not Included	1	Ask
NS19	00318640	Adjustable Supporter Assy	(421~425)		2	
401	00099660	Lift Arm Pin			2	
402	90980620	Roll Pin	SRP0620		4	
403	90981020	Roll Pin	SRP1020		4	
404	91000815	Socket Head Cap Bolt	HSF0815		2	
405	11316722	Lock Gear			2	
406	80845025	Snap Ring	RR040		2	
407	04548360	Lift Arm R			1	
408	91040815	Socket Head Cap Bolt	HSR0815		2	
409	90930508	Spring Washer	SW08SE		2	
410	90930708	Flat Washer	PW08SE		2	
411	04548380	L Slide Arm			2	
412	90760610	Socket Head Cap Bolt	HSBS0610		2	
413	04548420	Lift Arm L			1	
421	90940810	Round Head Screw	MSR0810SE		8	
422	11328460	Support Pad	Shore 80	Export Model	2	
423	00099682	Adjustable Supporter			2	
424	11319951	Adjustable Nut			2	
425	90980430	Roll Pin	SRP0430		2	
(Option)						
	51300501	Support Pad (Deep Groove)			2	



S. Lift Arm R·L and Parts

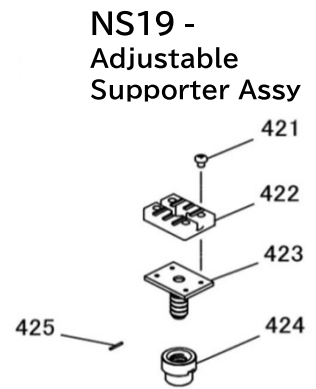
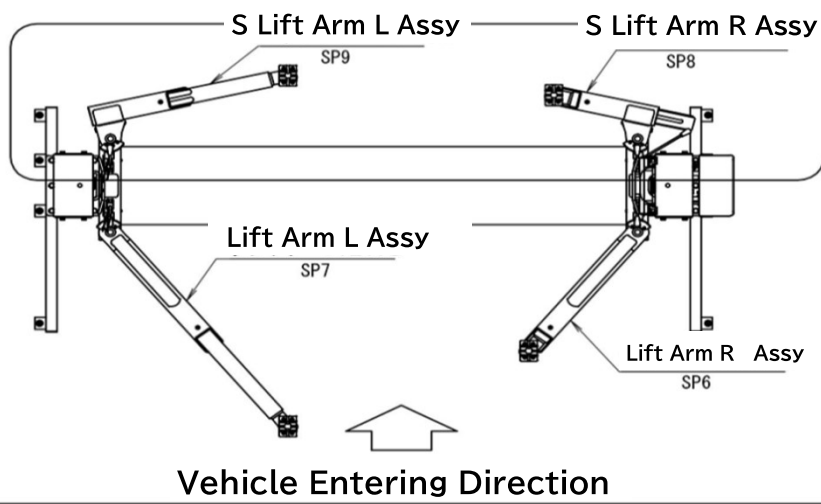

SP8
S. Lift Arm R Assy

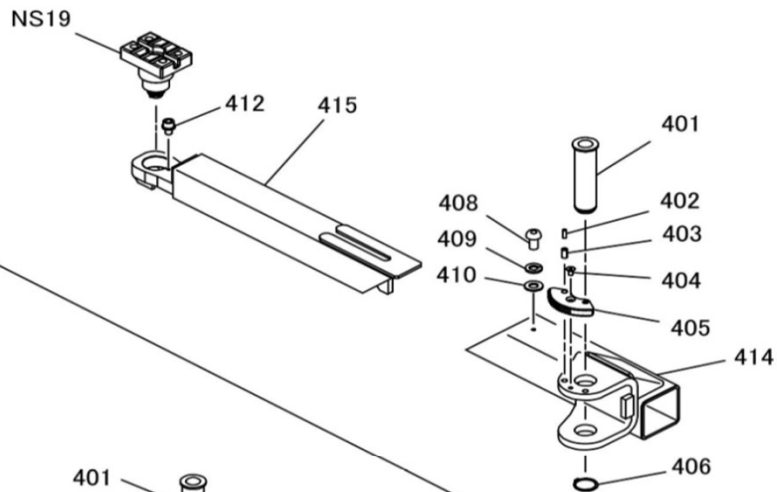

SP9
S. Lift Arm L Assy

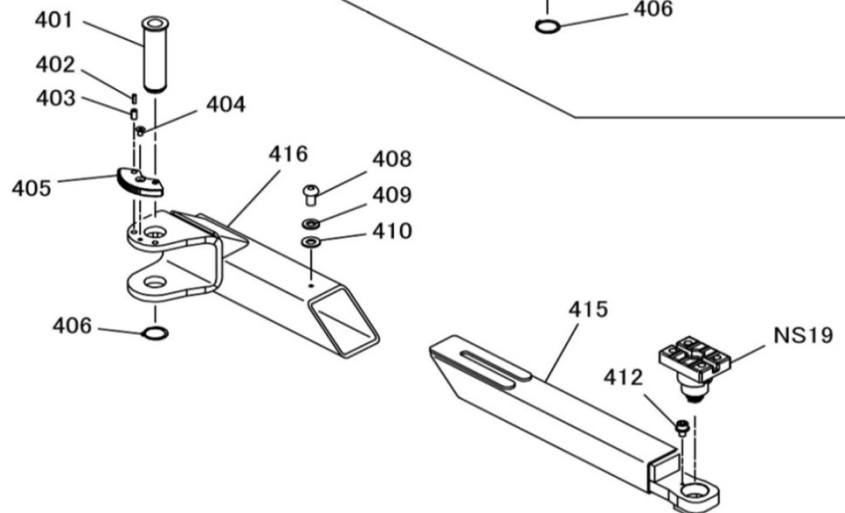

S. Lift Arm R·L and Parts

OSA3500NH

Ill. No.	Parts No.	Parts Name	Standard	Change Date & Note	Qty /Unit	Price/ea.
SP8	30318680	S Lift Arm R Assy	(401~406 · 408~410 · 412 · 414 · 415 · NS19)	After Sept. 2005	1	
	04548440	S Lift Arm R Assy	(401~406 · 408~410 · 412 · 414 · 415)	NS19 Not Included	1	Ask
SP9	30318700	S Lift Arm L Assy	(401~406 · 408~410 · 412 · 415 · 416 · NS19)	After Sept. 2005	1	
	04548500	S Lift Arm L Assy	(401~406 · 408~410 · 412 · 415 · 416)	NS19 Not Included	1	Ask
NS19	00318640	Adjustable Supporter Assy	(421~425)		2	
401	00099660	Lift Arm Pin			2	
402	90980620	Roll Pin	SRP0620		4	
403	90981020	Roll Pin	SRP1020		4	
404	91000815	Socket Head Cap Bolt	HSF0815		2	
405	11316722	Lock Gear			2	
406	80845025	Snap Ring	RR040		2	
408	91040815	Socket Head Cap Bolt	HSR0815		2	
409	90930508	Spring Washer	SW08SE		2	
410	90930708	Flat Washer	PW08SE		2	
412	90760610	Socket Head Cap Bolt	HSBS0610		2	
414	04548460	S. Lift Arm R			1	
415	04548481	S. Slide Arm			2	
416	04548520	S. Lift Arm L			1	
421	90940810	Round Head Screw	MSR0810SE		8	
422	11328460	Support Pad	Shore 80	Export Model	2	
423	00099682	Adjustable Supporter			2	
424	11319951	Adjustable Nut			2	
425	90980430	Roll Pin	SRP0430		2	
(Option)						
	51300501	Support Pad (Deep Groove)			2	

The image shows two black, rectangular support pads. The pad on the left has a deep, narrow groove in the center and is labeled '51300501' and 'Deep Groove'. The pad on the right has a shallower, wider groove in the center and is labeled '11328460 (Standard)' and 'Shallow Groove'. Both pads have four circular holes, one in each corner.

History and Applicable Adjustable Supporter Assy (Information for Reference)

(Current) After Sept. 2005

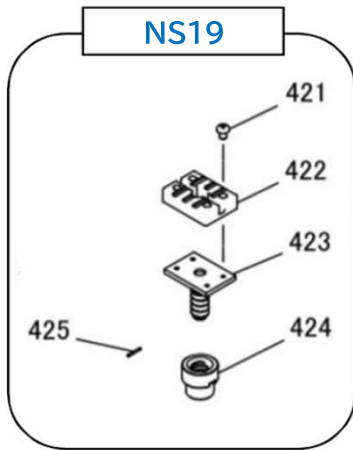

Dec. 1987 ~ Aug. 2005

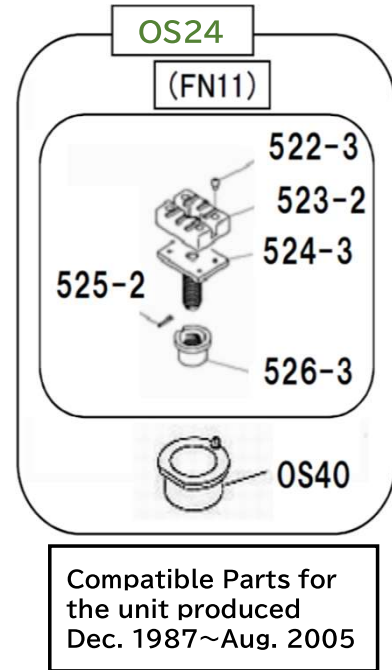

Reference Information of Very Old Adjustable Supporter



Before June 1992

※ Not Available

July 1992 ~ Aug. 2005

Can be replaced with OS24

History and Applicable Adjustable Supporter Assy

Ill. No.	Parts No.	Parts Name	Standard	Change Date & Note	Qty/Unit			Price/ea.
					OSP3000	OSP3500 OSA3500	NSP3500 NSA3500	
NS19	00318640	Adjustable Supporter Assy	(421~425)	After Sept. 2005		4		
OS24	00120410	Adjustable Supporter Assy	FN11 + OS40	Nov. 1987~Aug. 2005		4		
		Note : If Shallow groove Pad is required, Specify "With Shallow Groove Pad"						
OS40	00100090	Adjustable Nut Support		For the Arm Before Aug. 2005		4		
FN11	00140880	Adjustable Support Assy		For the Arm Before Aug. 2005		4		
421	90940810	Round Head Screw	MSR0810SE			8		
422	11328460	Support Pad	Shore 80	Export Model		2		
423	00099682	Adjustable Supporter				2		
424	11319951	Adjustable Nut				2		
425	90980430	Roll Pin	SRP0430			2		
522-2	90940812	Round Head Screw	MSR0812SE	July 1992~Aug. 2005		16		
522-3	90940810	Round Head Screw	MSR0810SE	After Sept. 2005		16		
523-2	11328460	Support Pad (New)	HS80 - Shallow Groove			4		
524-2	N/A	Adjustable Support	Replace with OS24	Before Aug. 2005		4		N/A
524-3	00099682	Adjustable Support		After Sept. 2005		4		
525-1	90980440	Roll Pin	SRP0440	Before Aug. 2005		4		
525-2	90980430	Roll Pin	SRP0430	After Sept. 2005		4		
526-3	11314980	Adjustable Nut S		After Sept. 2005		4		

Optional Frame Attachment (Truck Adaptor)

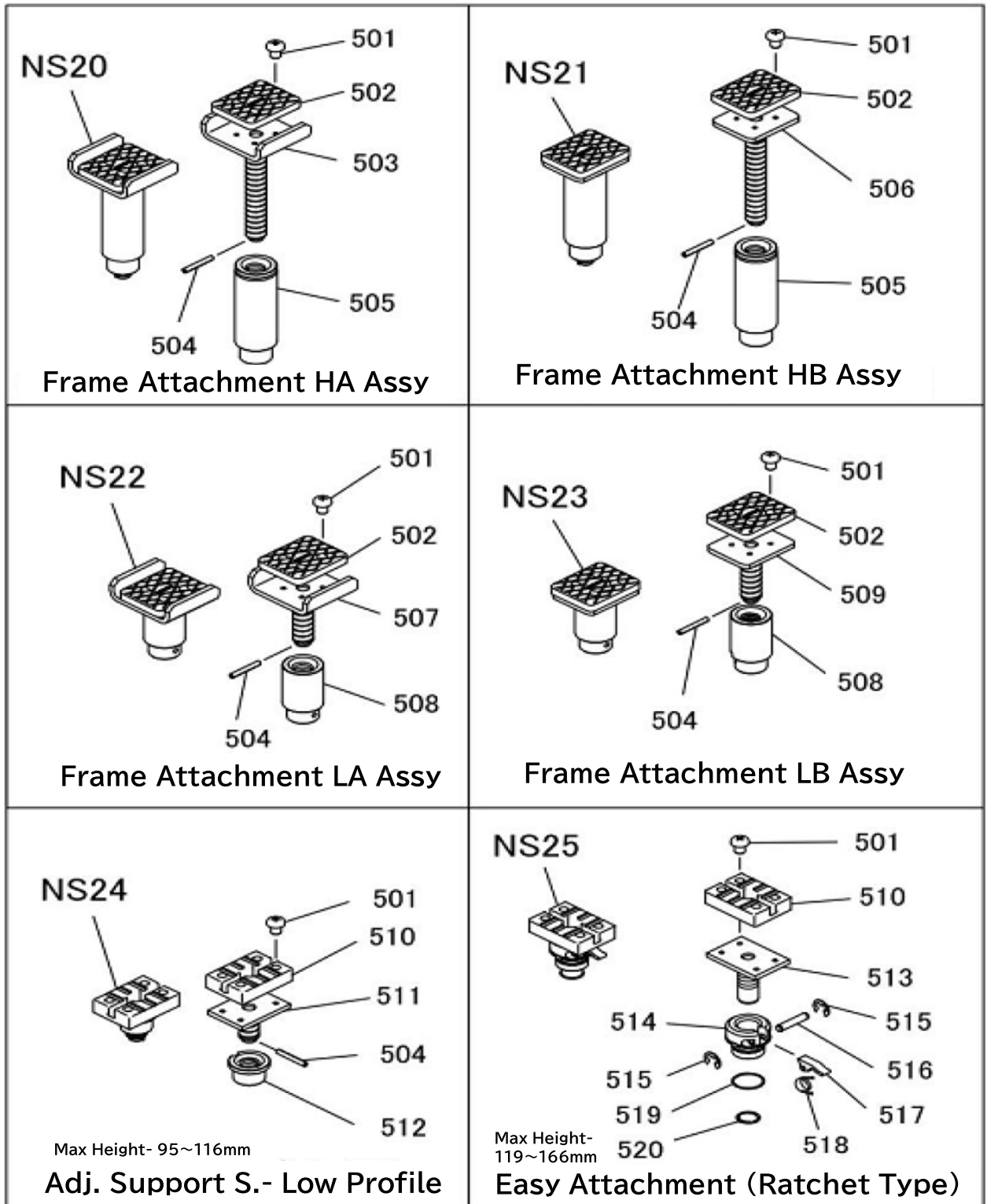

Frame Attachment Holder

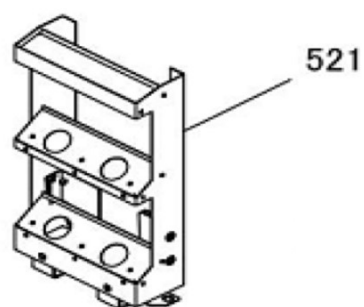

Optional Frame Attachment (Truck Adaptor)

Ill. No.	Parts No.	Parts Name	Standard	Change Date & Note	Qty/Unit			Price/ea.
					OSP3000	OSP3500 OSA3500	NSP3500 NSA3500	
NS20	04541281	Frame Attachment HA Assy	(501~505)			4		
501	90940810	Round Head Screw	MSR0810SE			16		
502	50564212	Support Pad				4		
503	04541301	Adjustable Support HA	Replace by NS20			4		
504	90980430	Roll Pin	SRP0430			4		
505	04541321	Supporter	Replace by NS20			4		
NS21	04541341	Frame Attachment HB Assy	(501 · 502 · 504~506)			4		
501	90940810	Round Head Screw	MSR0810SE			16		
502	50564212	Support Pad				4		
504	90980430	Roll Pin	SRP0430			4		
505	04541321	Supporter	Replace by NS20			4		
506	04541361	Adjustable Support HB	Replace by NS20			4		
NS22	04541380	Frame Attachment LA Assy	(501 · 502 · 504 · 507 · 508)			4		
501	90940810	Round Head Screw	MSR0810SE			16		
502	50564212	Support Pad				4		
504	90980430	Roll Pin	SRP0430			4		
507	04541400	Adjustable Support LA				4		
508	11251160	Adjustable Nut C				4		
NS23	04541420	Frame Attachment LB Assy	(501 · 502 · 504 · 508 · 509)			4		
501	90940810	Round Head Screw	MSR0810SE			16		
502	50564212	Support Pad				4		
504	90980430	Roll Pin	SRP0430			4		
508	11251160	Adjustable Nut C				4		
509	04541440	Adjustable Support LB				4		
NS24	Ask	Adjustable Support S Assy	(501 · 504 · 510~512)	Ask Bishamon		4	Ask	
501	90940810	Round Head Screw	MSR0810SE			16		
504	90980430	Roll Pin	SRP0430			4		
510	11328460	Support Pad	Shore 80	Export Model		4		
511	00100080	Adjustable Support S				4		
512	11314980	Adjustable Nut S				4		
NS25	Ask	Easy Attachment Assy	(501 · 510 · 513~520)	Ask Bishamon		4	Ask	
501	90940810	Round Head Screw	MSR0810SE			16		
510	11328460	Support Pad	Shore 80	Export Model		4		
513	N/A	Adjustable Support N	Replace with NS25			4	N/A	
514	N/A	Adjustable Nut N	Replace with NS25			4	N/A	
515	80847506	E Shape Snap Ring	E5SE			8		
516	10176340	Adjust Hook Shaft				4		
517	10176320	Adjust Hook				4		
518	10176360	Adjust Hook Spring				4		
519	80800125	O Ring	G45			4		
520	80845230	Snap Ring	ISTW30			4		
521	04541060	Attachment Holder Assy				2		

Caution Labels OSA3500NH

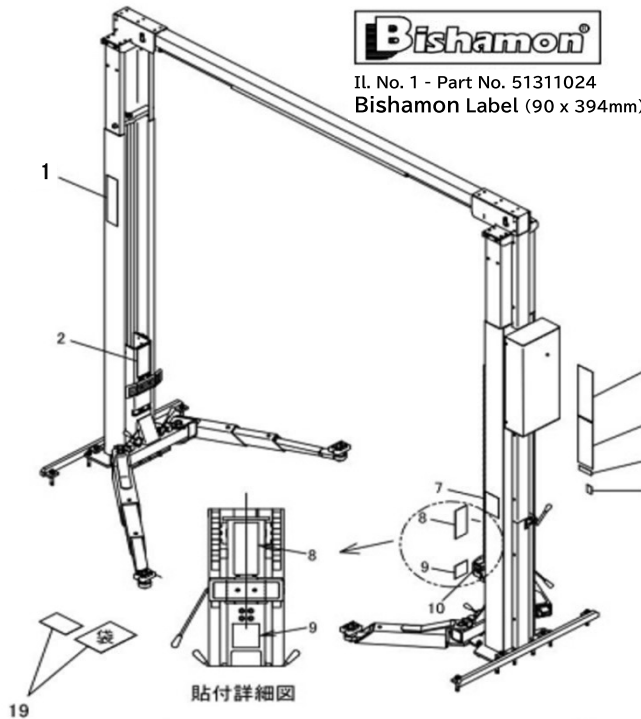

Bishamon®
Il. No. 1 - Part No. 51311024
Bishamon Label (90 x 394mm)

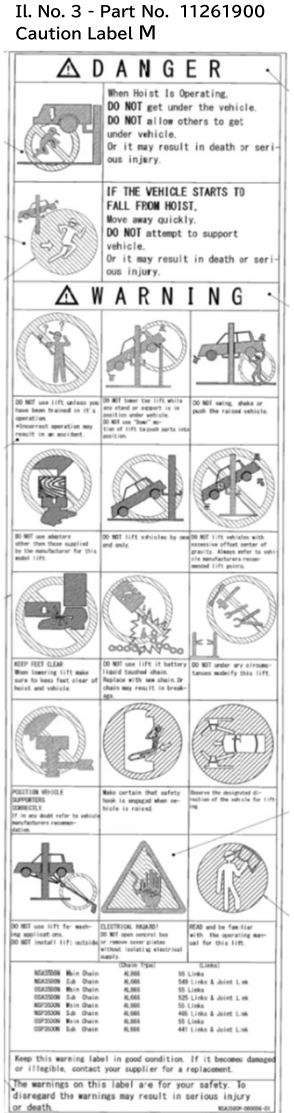

Il. No. 5 - Part No. Ask Bishamon
Serial Plate

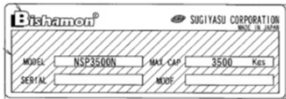

Il. No. 6 - Part No. 51311420
Function Sticker D

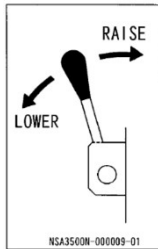

Il. No. 10 - Part No. 51311400
Function Sticker C

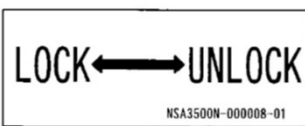

Part No. 38000656
Chain & Cable Replacing Schedule Label

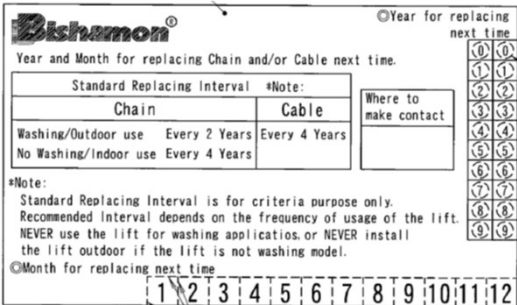

Il. No. 8 - Part No. 11261820
Caution Label F (Main Post Side)

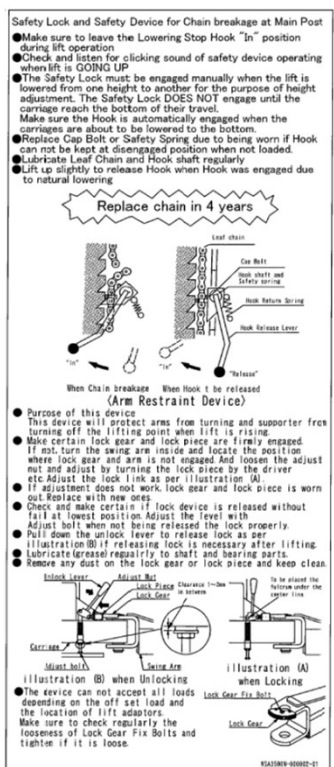

Il. No. 2 - Part No. 11261840
Caution Label G (Sub Post Side)

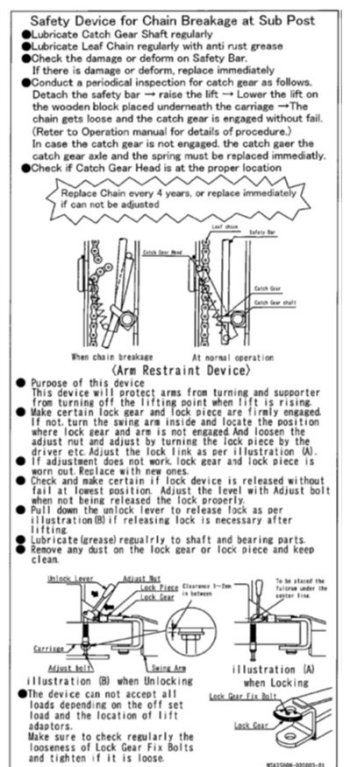

Il. No. 9 - Part No. 11261920
Caution Label

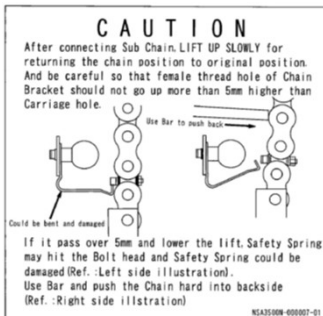

Il. No. 7 - Part No. 11261860
Caution Label H

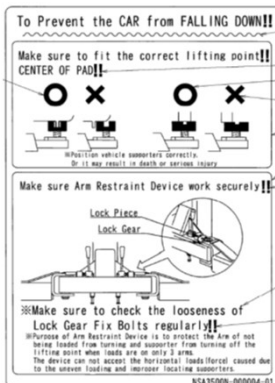

Bishamon



Sugiyasu Corporation

3-21, 4-Chome, Hongo-Cho, Takahama City,
Aichi, Japan 444-1394

Tel. 81-566-53-1126, Fax. 81-566-53-1844
<http://www.bishamon.co.jp/>